

File Name: 91 nissan 240sx service manual.pdf

Size: 3164 KB

Type: PDF, ePub, eBook

Category: Book

Uploaded: 22 May 2019, 13:10 PM

Rating: 4.6/5 from 606 votes.

Download Now!

Please check the box below to proceed.



I'm not a robot



reCAPTCHA
Privacy - Terms

Book Descriptions:

91 nissan 240sx service manual



This is your link to any FSM you need for the 240sx. Here are the specifics 8990 S13 KA24E 9194 S13 KA24DE 9294 S13 vert supplement 95 S14 KA24DE 96 S14 KA24DE OBDII 9798 S14 KA24DE All hosted by NICO for our members use. Please let us know if you have any troubles, or if were missing anything. Note. some members may have troubles downloading from time to time. This may be due to server speeds, internet connections, personal computer speeds, software, etc. Keep trying!! Ive had issues myself on occasion, then tried a few more time or come back a day later and gotten it to work. The best way to download is to right click and save to your hard drive, then open the file. You should put that up here with the booty CDs one. I use both whenever diagnosing problems. Ninja edit nevermind its in the link with all of them. Awesome job with the title BTW Thanks for the manuals! Got the job done thanks to these links.They are independent publications and are not affiliated with or endorsed by Nissan or Infiniti. Material may not be copied or reprinted without written permission. Page Count 952 Should be lubricated with grease. Unless otherwise indicated, useShould be lubricated with oil. Sealing point. Checking point. Always replace after every disassembly. Apply petroleum jelly. Apply A.T.F. Select with proper thickness. Adjustment is required. Service Data and Specifications. LeftHand, RightHandLeftHand Drive. RightHand Drive. Automatic Transmission Fluid. Drive range 1st gear. Drive range 2nd gear. Drive range 3rd gear. Drive range 4th gear. OverdriveTightening torqueWARNING indicates the possibility of personal injury if instructions are not followed. CAUTION indicates the possibility of component damage if instructions are not followed.ExampleROUTING in ELHARNES LAYOUT in ELInstrumentRed. Green. Blue. YellowOrange. Pink. Purple. Gray. Sky BlueIS gshown below. ExampleNormally closedPedals are not depressed and parking brake is released.<http://fc-junajted.com/upload/emu-proteus-1000-manual.xml>

- **91 nissan 240sx service manual, 91 nissan 240sx service manual instructions, 91 nissan 240sx service manual pdf, 91 nissan 240sx service manual download, 91 nissan 240sx service manual 2017.**

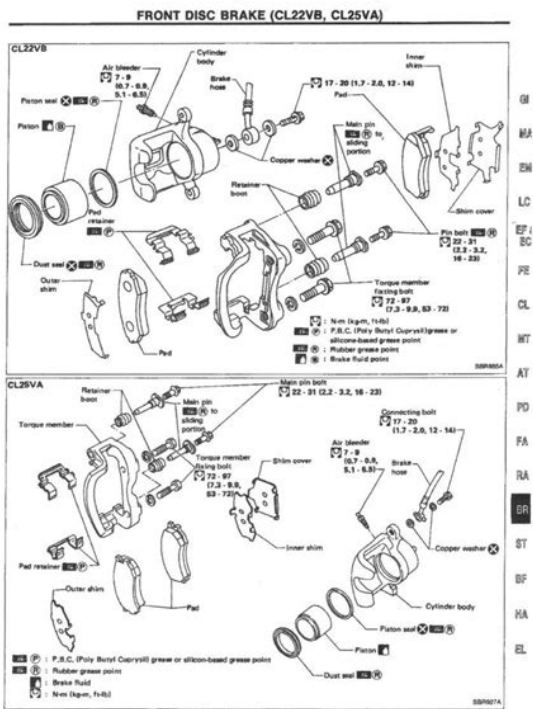

ExampleConnector guides for male terminals are shown in black andConnector. Connector symbol. Female terminal. E.fj. Guide. Connector. Connector symbolExampleExample Wiper switch in LO position. Continuity circuit. CID terminalManual. The foldout should be spread to read the entire wiringCheckRefer to last pageBRL.Resistance. Approximately. Check the following items.Observe the following instructions beforeIf you must perform circuit continuity between harnessStart to diagnose a problem using procedures indicated inBattery voltage should exist.Procedure,Required results are indicated in bold type in the corresponding block, as shown below. These have the following meaningsIllustrations are provided as visual aids for work procedures. For example, symbol m indicated in the left upper portionSymbols included in illustrations refer to measurements orExample. View from terminal side. DirectionView from harness side. ConnectorDirection. Direction mark. A direction mark is shown to clarify the side of connector terminal side or harness side. Direction marks are mainly used in the illustrations indicatingAll connector symbols shown from the terminal side areViewf,omhernessside.nSymbol. Symbol explanationSymbol explanation. Check after disconnecting theAIC switch. Check after connecting theInsert key into ignition switch.Apply battery voltage directly toDo not start engine,or check. Disconnect battery negative cable.Start engine.DepressApply parking brake. Release brake pedal. Release parking brake. Depress accelerator pedal. CffH. Check after engine is warmed upRelease accelerator pedal.Voltage should be measured with aCircuit resistance should beCurrentsshould be measuredwithFor details regarding theDestination. Model. Body. Transmission. Engine. CoupeN Canada. V CaliforniaA Automatic transmissionVehicle identificationVehicle identificationF.M.V.5.5. certification. Vehicle identificationEngine typeManufacture plant. W Kyushu. Model year.<http://www.hygradeinsulators.com/images/uploads/emu-proteus-2000-manual-pdf.xml>

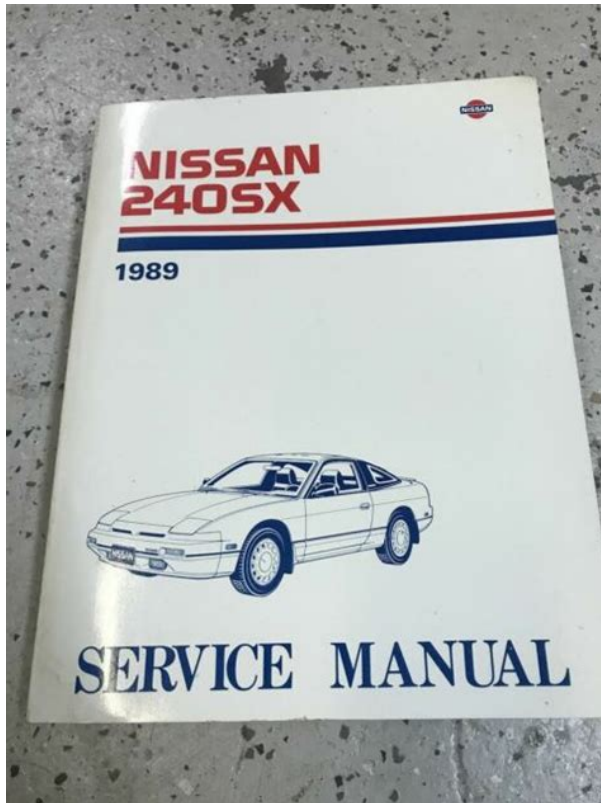

K 1989 year model The code for the check digit is Model change 0 to 91. Body type Restraint system. S Standard. P Automatic Vehicle identification number Chassis numbered. Body color code. Trim color code. Engine model. Engine displacement. Transmission model. Axle model Unit mm in. Coupe. Fastback. Overall length Road wheel. Steel Aluminum Offset. Tire size Spare Place wheel chocks at the front wheels when the rear When setting the lift arm, do not allow the arm to contact the Sill. Put the sill in the slit of the lift pad to prevent If the pad does not have Note. Liftup points It is necessary to use proper towing equipment to avoid Towing is in accordance with Towing Procedure Manual at When towing with the rear wheels on the ground, release NISSAN recommends that vehicle be towed with the driving Observe the following restricted towing speeds and distances. Speed. Distance. Less than 65 km 40 miles. If the speed or distance must necessarily be greater, remove Front. Rear Bolt size. Bolt Tightening torque Without lubricant. Pitch mm. Hexagon head bolt. N.m Hexagon flange bolt. N.m Mark Metric screw threads Under severe driving conditions, additional or The periodic maintenance schedule is repeated beyond the last mileage and period shown by returning to the Drive belts See NOTE 1. Replace every 30,000 miles Air cleaner filter. Vapor lines. Fuel lines. Fuel filter Engine oil Then replace every Ignition wires Spark plugs. Reference page Miles x 1,000 In such an event, replace them immediately. The owner need. Other maintenance items and intervals are required. Abbreviations If the vehicle Severe driving conditions. A Repeated short trips less than 5 miles 8 km and outside temperatures remain below freezing. C Driving in dusty conditions. D Driving on rough, muddy, or salt spread roads. E Towing a trailer, using a camper or a cartop carrier. Driving condition Maintenance Reference. More frequently Air cleaner filter Steering linkage ball joints. Exhaust system The owners can perform the Item.

Reference page Tires Check the pressure with a gauge periodically when at a service station, including the Check carefully for damage, cuts or Wheel nuts When checking the tires, make sure no nuts are missing, and check for any loose Tire rotation Tires should be rotated every 12,000 km 7,500 miles. Doors and engine hood Check that all doors and the engine hood operate smoothly as well as Also ensure, that all latches lock securely. Lubricate if necessary. Make sure that the secondary latch keeps the hood from opening when the primary When driving in areas using road salt or other corrosive materials, check lubrication frequently. Lights Make sure that the headlights, stop lights, taillights, t Turn signal lights, and other lights Also check headlight aim. Windshield wiper and washer

Check that the wipers and washer operate properly and that Windshield defroster Check that the air comes out of the defroster outlets properly and in Steering wheel Check that it has the specified free play. Be sure to check for changes in the Free play Less than 35 mm 1.38 in. Seats Check seat position controls such as seat adjusters, seatback recliner, etc. to ensure Check that the Check that the latches lock securely for folding down rear seatbacks. Check the belt Reference page. Clutch pedal Make sure the pedal operates smoothly and check that it has the proper free Brake pedal Check the pedal for smooth operation and make sure it has the proper distance Check the brake booster function. On a fairly steep hill check that your vehicle Windshield washer fluid Check that there is adequate fluid in the tank. Engine coolant level Check the coolant level when the engine is cold.

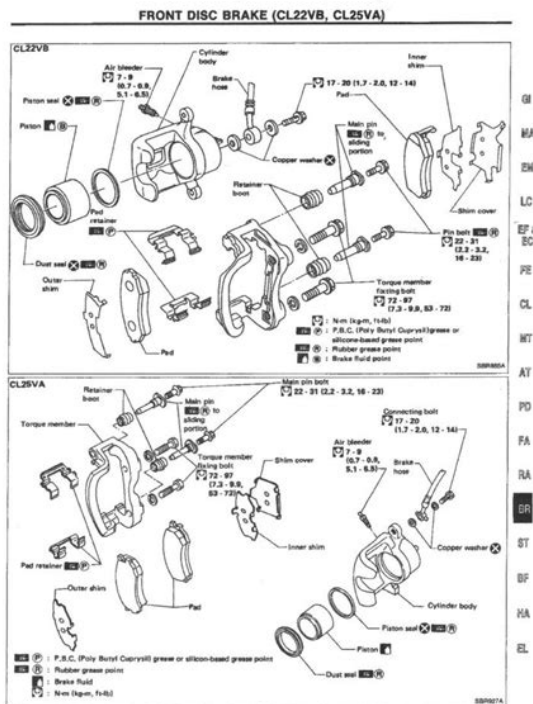

<https://ayurvedia.ch/bose-personal-music-center-ii-remote-control-manual>

Make sure the hoses have no cracks, deformation, rot or Brake and clutch fluid levels Make sure that the brake and clutch fluid levels are between the If the sound of the It is very important to remove these substances, otherwise Fluid leaks Check under the vehicle for fuel, oil, water or other fluid leaks after the vehicle Water dripping from the air conditioner after use is normal. If Capacity Approximate. Engine oil Refill. With oil filter. Without Cooling system with reservoir tank. Reservoir tank. Manual transmission. Differential Automatic transmission fluid. Power steering fluid. Recommended lubricants and fluids Imp Liter Type DEXRON DOT 3 US FMVSS No. 116. Multipurpose grease. NLGI No.2 Lithium soap base. These oils can be identified by such labels as energy conserving, energy saving, improved fuel economy, etc. Outside Temperature. Anticipated Anticipated Before Next Oil Change Before Next Oil Change T Tension checking points. IAJ Adjusting bolts. Checking Drive Belts Adjust if belt deflections exceed the limit. Belt deflection. Inspect drive belt deflections when engine is cold. Unit Set deflection of Limit. Adjusted Alternator Changing Engine Coolant Apply sealant to the thread of drain plug. Follow instructions attached to antifreeze container for Coolant capacity. With reservoir tank. Pour coolant through coolant filler neck slowly to allow air in Inspect fuel lines and tank for improper attachment and for If necessary, repair or replace faulty parts. Tighten high pressure rubber hose clamp so that clamp end is Ensure that screw does not contact adjacent parts. Be careful not to spill fuel over engine compartment. Place Use a high pressure

type fuel filter. Do not use a synthetic Air Cleaner. Filter. The viscous paper type filter does not need cleaning between Refill oil capacity Approximate. Front With oil filter change. Without oil filter change Drain plug Use recommended engine Oil. After several Oil Filter Refer to Changing Engine Oil. Do not pull on the wire. Spark plug.

<http://atamusavirlik.com/images/canon-i860-instruction-manual.pdf>

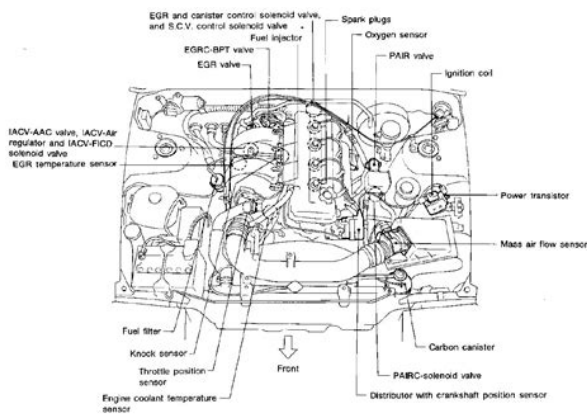

Standard type Reconnect ignition wires according to Spark plug Resistance. Less than 30 kil Refer to EVAPORATIVE EMISSION CONTROL SYSTEM If fluid level is extremely low, check clutch system for leaks. Min. Never start engine while checking oil level. Filler plug Oil capacity. Drain plug AIT Fluid Hot 50 aoc But it can be However, fluid level must If level is at low side of Do not overfill. Check fluid for contamination. If fluid is very dark or smells Refer to section AT for checking operation of AIT. Check fluid for contamination. AIT Fluid Oil capacity With torque converter Filler plug Differential Gear Oil Oil capacity. Drain plug Checking Disc Brake Unit mm in. Front. Rear Disc brake type. Standard thickness. Minimum thickness. Rear Adjust wheel balance using road wheel center. Wheel balance Maximum allowable unbalance Refer to S.D.S. Tire balancing weight Refer to S.D.S. Wheel nuts Check connection with steering column for looseness. For automatic seat belt, refer to BF section. Rear seat belt. Check function of Front seat belt Spark plug Unit mm in. Used belt deflection. Adjusted Limit. Alternator. Set deflection of Ignition wire. Resistance kS1 Standard type Nm Spark plug Unit 2 US qt, Imp qt. Without Coolant capacity. Unit 2 US qt, Imp qt. With reservoir Drain plug. Less than 30 Brake Unit mm in. Unit mm in Pad. Standard thickness Caster Toe in Standard thickness Full turn Free height Toe out Parking brake. Number of notches Wheel bearing axle end Wheel bearing lock nut. Tightening torque. N.m kgm, ftlb. Rear Wheel balance Tire balance weight Nm. Clutch. Pedal stopper lock nut. Clutch switch lock nut Final drive. Drain plug Front axle and front Tierod lock nut Camber adjusting pin. Rear axle and rear Toe adjusting pin Air bleed valve Wheel nut Bolt hole Be sure liquid gasket is 2.0 to 3.0 mm 0.079 to 0.118 in Tool name. Description Idle speed More than 78 0.8, 11 Gasket N.m kgm, ftlb Punch When removing oil pump, turn crankshaft so that No.

<http://www.dolciariavarone.com/images/canon-i9950-printer-service-manual.pdf>

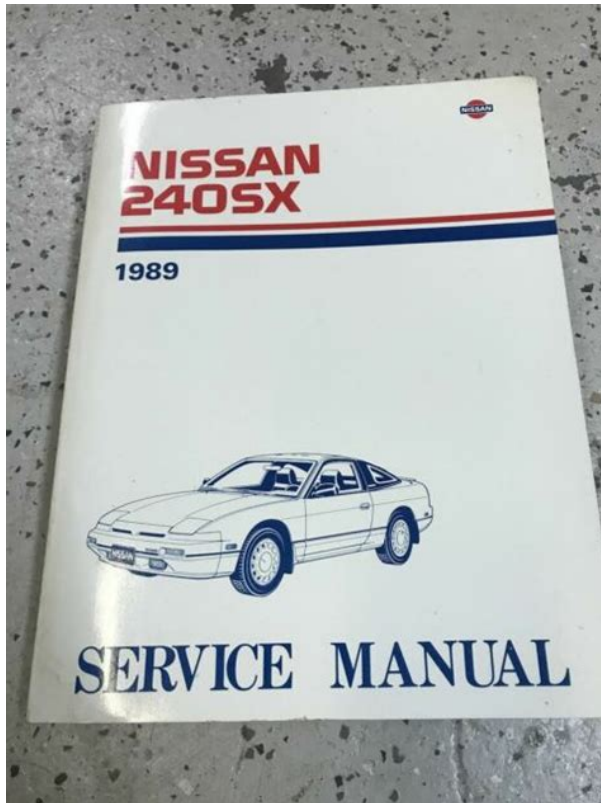

1When installing oil pump, align punchmark on drive spindleOilFrontIf damaged, replace regulator valve set or oil pump assembly.If replacement is necessary, removeInstall a new valve in place by tapping it.Rotor. Less than 0.12 0.0047Outer rotor to body clearance. Side clearance with gasket CIDThermostat. Open. Thermostat. Closed. Radiator. Intake man ifold. ThermostatWrap a thick cloth around cap and carefully remove the capCHECKING COOLING SYSTEM FOR LEAKS. To check for leakage.Testing pressureRadiator cap relief pressureRemove liquid gasket from mating surface of pump housingClean all traces of liquid gasket using white gasoline.Use Genuine Liquid Gasket or equivalent.Cut here.It should sea.ttightly. Water inletUpward. Jiggle valveValve opening temperatureSimilarly, remove liquid gasket from mating surface ofClean all traces of liquid gasket using white gasoline.Use Genuine LiqLJidGasket or equivalent.NmIkmgm,ftlbCooling FanI amp.Even though air conditioner operates normally under highIuBattery voltage should exist. Check subharness for thermoswitch continuity. If N.G., repairCheck the followingsIf N.G. replace them.ContinuityY. Above. Yes. Below. NoContinuity should exist. If N.G., repair harness.Battery voltage should exist.IiContinuity should exist. If N.G. replace condenser fanBattery voltage should exist.Continuity should exist.Oil pump. Oil pressure check. Unit. Engine rpm. Approximate discharge pressure. Idle speed. More than 78 0.8, 11Less than 0.12 0.0047. Outer rotor to body clearanceThermostat. Valve opening temperature. Max. valve liftCap relief pressure. Leakage test pressureSee pullout following EL section.Tool nameDescription. MeasuringDo not turn diagnosis modeHowever, this is not an indicationBefore connecting or disconnecting E.C.U.

connector, makeAlways install the properlyDisconnect connector by pulling it not the harness straightBefore connecting connector,Do not let them run parallel forDo not apply battery power directly to injectors; otherwiseDo not reverse polarity of battery when connecting it.Do not reuse fuel hose clamps. Tighten fuel hose clamps toDo not disassemble air flowDo not clean air flow meterImmediately after starting, doA poor connection can causeKeep E.C.C.S. harness at leastE.C.C.S. systemri malfunctionKeep E.C.Cs parts and harnesses dry. Before removing parts, turn offFuel pumpExhaust gasPressure regulator. PressureLA.A. unit. S.C.V.control. Fuel filterIgnition coil andDistributorExhaust gas temperature sensor I.ThrottleTransmissionExhaustA.I.V. controlExhaustgasflow. Air flow meAir flow meterIgnition switchIdle switchIdle speed control. Auxiliary air controlA.I.V. control. AI.V. control solenoid valve. Canister control. E.G.R. control

solenoid Ignition timing control Fuel pump control Air regulator control. Air regulator. Acceleration cut Air conditioner relay. S.C.V. Swirl control S.C.V. control Exhaust gas sensor. Inspection lamps Pressure regulator Pressure regulator control Inhibitor switch A/T. Vehicle speed sensor Battery Failsafe function E.G.R. control Air regulator Canister Air duct To tachometer Idle NO.4 and 6 The fuel injector is a small, elaborate solenoid valve. As the E.C.U. sends injection signals to the injector, the coil in the injected fuel is controlled by the E.C.U. in terms of injection pulse duration. Brass wire is used in the injector coil and thus the resistance is Intake manifold. The pressure regulator maintains the fuel pressure at 299.1 kPa. Since the injected fuel amount depends Air chamber Fuel return To Louver. Holder. Isolation bushing. Contact plate The sensor has a closed end tube made of ceramic zirconia. The outer surface of the tube is exposed to exhaust gas, and The zirconia of the tube In order to improve the The radical change from 1V to.

<http://www.megasaludips.com/wp-content/plugins/formcraft/file-upload/server/content/files/162752ce97a945--brother-mfc-5490cn-printer-manual.pdf>

OV occurs at around the ideal mixture ratio. In this way, the Mixture ratio Outlet The fuel pump with a fuel damper is a submergible type, and Motor The ignition signal from the E.C.U. is amplified by the power A bimetal, heater and rotary shutter are built into the air The I.A.A. unit is made up of the A.A.C. valve, F.I.C.D. solenoid It receives the signal from the E.C.U. The F.I.C.D. solenoid valve compensates for changes in idle Idle Air The power steering oil pressure switch is attached to the power Vehicle Speed Sensor Reed. Reed. I/me I The vehicle speed sensor provides a vehicle speed signal to the Field plate The E.G.R. control valve controls the quantity of exhaust gas to. To E.G.A. Vacuum signal source. Air The B.P.T. valve monitors exhaust pressure to activate the E.G.R. control valve. In other words, recirculated exhaust gas is Exhaust pressure The air induction valve sends secondary air to the exhaust The A. LV. control solenoid valve cuts the intake manifold When the control unit E.G.R. Control Solenoid Valve Pressure Regulator P.R. Control Solenoid. Valve. E.C.U. When it is off, a vacuum signal from the intake manifold When the control unit sends S.C.V. Control Solenoid Valve. The S.C.V. control solenoid valve cuts the intake manifold It responds to the When the control Fuel Filter. The specially designed fuel filter has a metal case in order to The carbon canister is filled with active charcoal to absorb. These absorbed The vacuum in the intake passage upstream of the throttle valve When the vacuum of the intake passage is higher than a preset The check connector for E.C.C.S. checker box is beside fuse The exhaust gas temperature sensor monitors in exhaust gas Electric resistance of the thermistor Engine speed and piston position. Crank angle sensor. Amount of intake air. Air flow meter Engine temperature Density of oxygen in exhaust gas. Exhaust gas sensor. Throttle Throttle valve position. Throttle valve idle position. Idle switch. Neutral switch M/T. Inhibitor switch A/T Injector.

<http://bacvietexpress.com/upload/userfiles/files/continental-tmd27-manual.pdf>

Gear position. Vehicle speed. Vehicle speed sensor. Ignition switch. Start signal. Battery voltage. Battery Low High Exhaust In J Injector The control unit adjusts the injection This stage refers to the closed loop control condition. The E,C,U. detects any of the following conditions and feedback However, the basic mixture Accordingly, a difference between the basic and theoretical Injection pulse No.2 cylinder No.3 cylinder No.4 cylinder No.1 cylinder JI No.2 cylinder. JI No.3 cylinder. JI Fuel is injected once a cycle for each cylinder in the firing order. When engine starts, fuel is injected Ignition Timing Control. Engine speed and piston position. Air flow meter. Engine temperature. Engine temperature sensor. Throttle sensor. Inhibitor switch A/T. Throttle valve idle position Throttle valve opening angle. Neutral position. Ignition switch The ignition timing data is stored in the ROM The E.C.U. detects information such as the injection pulse width and crank angle sensor signal Then responding to N 1,800 rpm, Tp 1.50 msec. In addition to this, Tp Engine speed Engine temperature sensor Start signal Neutral F.I.C.D. solenoid valve Battery. I Vehicle speed sensor Idle speed is controlled The optimum Ignition switch Start signal The E.C.U. activates the fuel

pump for several E.C.U. stops pump operation and prevents batteryIt controls. Ignition switch is turned to ON. Engine running and cranking. Fuel pump operation. Operates for Operates. When engine is stopped. Stops in 1 second. Except as shown above. Stops. Air Regulator Control. Engine speed Start signal. Ignition switch The air regulator is controlled by the E.C.U. at the Ignition switch is turned to ON. While engine is running and Air regulator Operates for Operates. OFF in 1 second. Except as shown above Engine temperature. Engine temperature sensor. Throttle valve idle position Engine speed. A.L.V. control Vehicle speed The exhaust pressure in the exhaust manifold If a secondary air intake pipe is opened to the The air induction valve is controlled by the E.C.C.S.

When the engine is cold, the A.I.V. control In extremely cold conditions, A.I.V. control system Engine condition. Water temperature. A.L.V. control solenoid A.L.V. control system. Idle or deceleration. Between 28 82 and Engine speed. Crank angle sensor Air flow meter Engine temperature E.G.R. valve to suit engine operating conditions. This cut and control operation is accomplished E.G. R. control solenoid valve operation. E.G. R. control solenoid valve. Condition. When starting. Below 60 140. Water temperature E.G.R. system operation. E.G. R. system operates under only the following conditions. B.P.T. valve.

<https://skazkina.com/ru/bose-personal-music-center-ii-remote-control-manual>